

## ★ Woodlands of Lombard

### Area Public Schools

- 1 G. Stanley Hall Elementary
- 2 Marquardt Middle School
- 3 Glenbard East High School

### Area Parks

- 4 East Branch Forest Preserve
- 5 Armitage Park
- 6 Harold A. Reskin Park
- 7 Ackerman Park
- 8 Churchill Woods Forest Pres.
- 9 Terrace View Park
- 10 Fullerton Park Forest Pres.
- 11 Army Trail Nature Center
- 12 Kerry Park
- 13 Sunnyside Park
- 14 Gilmer Park
- 15 Lombard Commons Park
- 16 Westmore Woods Park
- 17 Lagoon Park
- 18 Lake Manor Park

### Area Shopping Centers

- Yorktown (11 min/7.25 miles)
- Stratford Square (14 min/6.53 miles)
- Oak Brook (17 min/10.90 miles)

### Area Private Schools

- St. Matthew Day School  
*(Preschool-8; Glendale Hts, 3 miles)*
- Montini Catholic High School  
*(Lombard, 8 miles)*
- St. Pius X Elementary School  
*(Lombard, 5.5 miles)*
- Christ the King School  
*(Preschool-8; Lombard, 6 miles)*
- College Preparatory School of IL  
*(K-12; Lombard, 4 miles)*
- St. John's Lutheran School  
*(Preschool-8; Lombard 3.5 miles)*
- Sacred Heart School  
*(K-8; Lombard, 3 miles)*
- St. Timothy Ev. Lutheran School  
*(Preschool-4; Lombard, 2.5 miles)*
- Trinity Lutheran School  
*(Preschool-8; Lombard, 7 miles)*

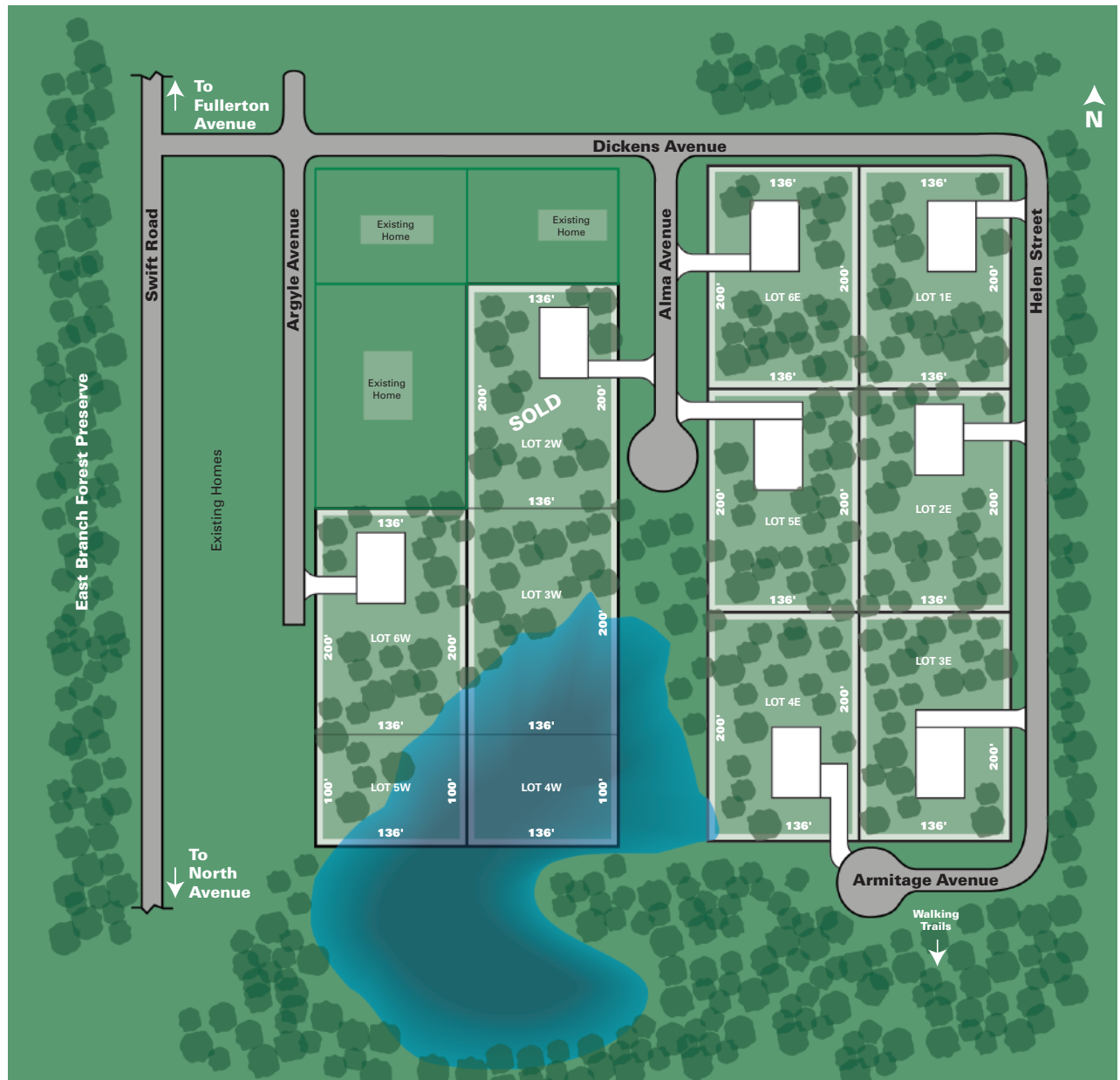

# WOODLANDS OF LOMBARD

Eight large wooded lots, a large body of water and walking trails at the south end make this a beautiful, quiet setting for homeowners to enjoy nature. The Woodlands of Lombard is adjacent to the East Branch Forest Preserve, with convenient access to I-355. It is just minutes from nearby Oak Brook, Yorktown and Stratford Square shopping centers and is centrally located near both public and private schools, parks and recreational areas.

**Infinity**  
Construction & Remodeling Inc.  
Phone : 630-530-4907 Fax : 630-530-4937  
www.infinityconstruction.us